

G-LINE

# HIGH EFFICIENCY FANS FOR AGRICULTURAL AND INDUSTRIAL APPLICATIONS

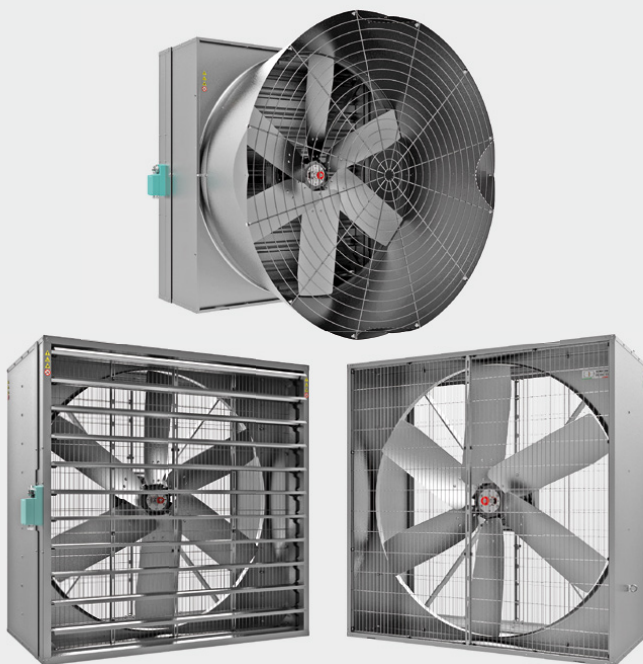

since  
1967



State-of-the-art direct-driven exhaust fan with high technology brushless motor. Wallhousing in strong galvanized steel and shutter blades in aluminium to ensure high corrosion resistance. 6-blade-propeller in Peraluman with optimized profile, designed to guarantee an excellent airflow/efficiency both at extreme pressure and low airspeed. Integrated PID controller.



Removable motorised shutter, for easy maintenance and inspection

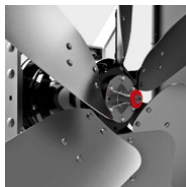

Direct-drive brushless motor, 3 configurable inputs/outputs (digital input on-off, 0-10V speed control input, 0-10V analog output)



Practical fixing strips for wall installation



Sturdy motor's brackets to avoid impeller vibrations

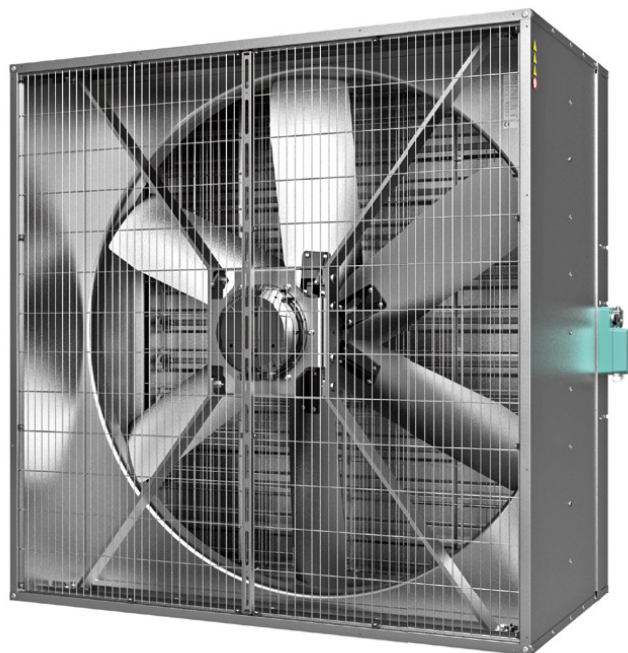

## Technical features

# G EOS 53

G EOS 53 - test number Bess Lab: 22361

Model	Voltage	Frequency	Propeller rotation speed (0 Pa - 0 inH <sub>2</sub> O)	Air flow				Absorbed power (0 Pa - 0 inH <sub>2</sub> O)	Absorbed power (25 Pa - 0.10 inH <sub>2</sub> O)	Specific power input (0 Pa - 0 inH <sub>2</sub> O)	Specific power input (25 Pa - 0.10 inH <sub>2</sub> O)	Ventilating Efficiency Ratio (0 Pa - 0 inH <sub>2</sub> O)	Ventilating Efficiency Ratio (25 Pa - 0.10 inH <sub>2</sub> O)
				0 Pa 0 inH <sub>2</sub> O	12 Pa 0.05 inH <sub>2</sub> O	25 Pa 0.10 inH <sub>2</sub> O	50 Pa 0.20 inH <sub>2</sub> O						
G EOS 53	3ph - 380-480V	50/60 Hz	560 RPM	29.100 cfm	28.300 cfm	27.400 cfm	25.600 cfm	2188 W	2407 W	44 W/ (1000m <sup>3</sup> /h)	52 W/ (1000m <sup>3</sup> /h)	13,3 cfm/W	11,4 cfm/W
				49.500 m <sup>3</sup> /h	48.100 m <sup>3</sup> /h	46.500 m <sup>3</sup> /h	43.500 m <sup>3</sup> /h						
			500 RPM	26.200 cfm	25.100 cfm	24.100 cfm	21.800 cfm	1560 W	1745 W	35 W/ (1000m <sup>3</sup> /h)	43 W/ (1000m <sup>3</sup> /h)	16,8 cfm/W	13,8 cfm/W
				44.400 m <sup>3</sup> /h	42.700 m <sup>3</sup> /h	41.000 m <sup>3</sup> /h	37.100 m <sup>3</sup> /h						
			450 RPM	23.500 cfm	22.500 cfm	21.200 cfm	18.500 cfm	1148 W	1302 W	29 W/ (1000m <sup>3</sup> /h)	36 W/ (1000m <sup>3</sup> /h)	20,5 cfm/W	16,3 cfm/W
				39.900 m <sup>3</sup> /h	38.200 m <sup>3</sup> /h	36.100 m <sup>3</sup> /h	31.400 m <sup>3</sup> /h						
			390 RPM	20.300 cfm	19.000 cfm	17.600 cfm	14.500 cfm	775 W	907 W	22 W/ (1000m <sup>3</sup> /h)	30 W/ (1000m <sup>3</sup> /h)	26,2 cfm/W	19,4 cfm/W
				34.500 m <sup>3</sup> /h	32.400 m <sup>3</sup> /h	29.900 m <sup>3</sup> /h	24.700 m <sup>3</sup> /h						
			340 RPM	17.800 cfm	16.200 cfm	14.400 cfm	10.300 cfm	540 W	634 W	18 W/ (1000m <sup>3</sup> /h)	21 W/ (1000m <sup>3</sup> /h)	32,9 cfm/W	22,7 cfm/W
				30.200 m <sup>3</sup> /h	27.600 m <sup>3</sup> /h	24.500 m <sup>3</sup> /h	17.500 m <sup>3</sup> /h						

Tested according to ANSI/AMCA 210-07 ANSI/ASHRAE 51-07 complying with ASABE/S565 OCT 2005.  
**Note:** All fans tested with shutter and protection net.



## Dimensions and loading possibilities

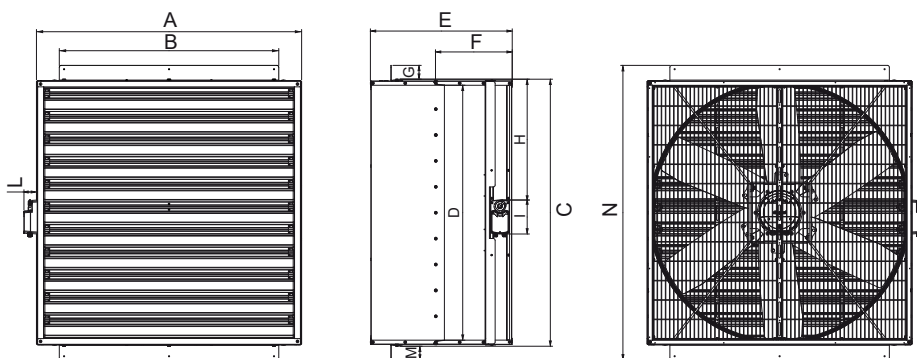

Dimension	G EOS 53
Dimension - A - [mm]	1389
Dimension - B - [mm]	1150
Dimension - C - [mm]	1399
Dimension - D - [Ø mm]	1336
Dimension - E - [mm]	743
Dimension - F - [mm]	402
Dimension - G - [mm]	72
Dimension - H - [mm]	633
Dimension - I - [mm]	178
Dimension - L - [mm]	65.5
Dimension - M - [mm]	72
Dimension - N - [mm]	1544

Characteristics	G EOS 53
Weight - kg	133

Loading possibilities on pallet	G EOS 53
Fully assembled version (FA)	
LxWxH - mm	1460x2250x2250
N° pieces	4
Gross weight - kg	580

Loading possibilities	Fully assembled version (FA)	Knock-down version (KD)
Container 20ft	16	100
Container 40ft	32	180
Truck	36	180

State-of-the-art brushless motor direct-driven cone fan. Wallhousing in strong galvanized steel and shutter blades in aluminium to ensure high corrosion resistance. Optimized 6-blade-propeller shape in Peraluman, designed to guarantee an excellent airflow/efficiency both at extreme pressure and low airspeed. Integrated PI controller.

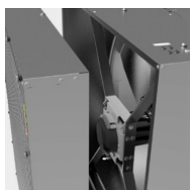

Removable motorised shutter, for easy maintenance and inspection

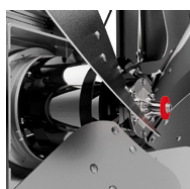

Direct-driven brushless motor, 3 configurable inputs/outputs (digital input on-off, 0-10V speed control input, 0-10V analog output)



Security grid on the squared cone



**NT** safety net on air intake side

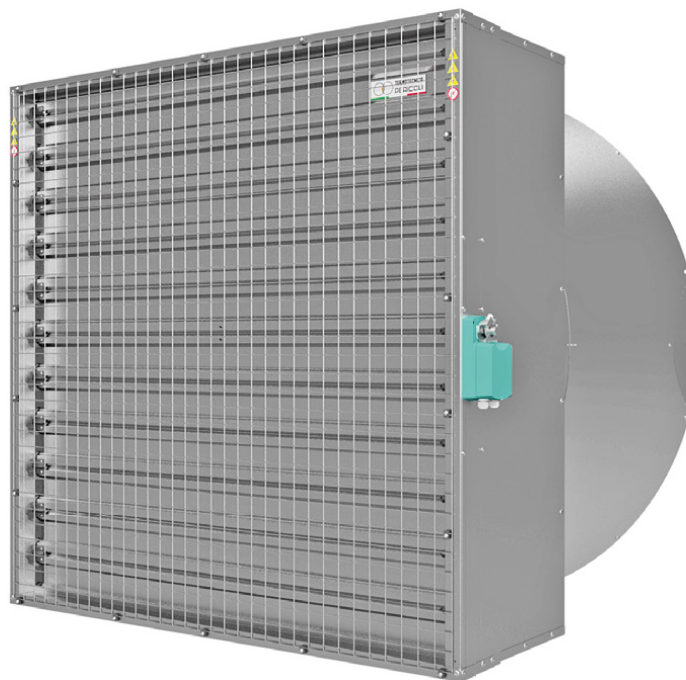
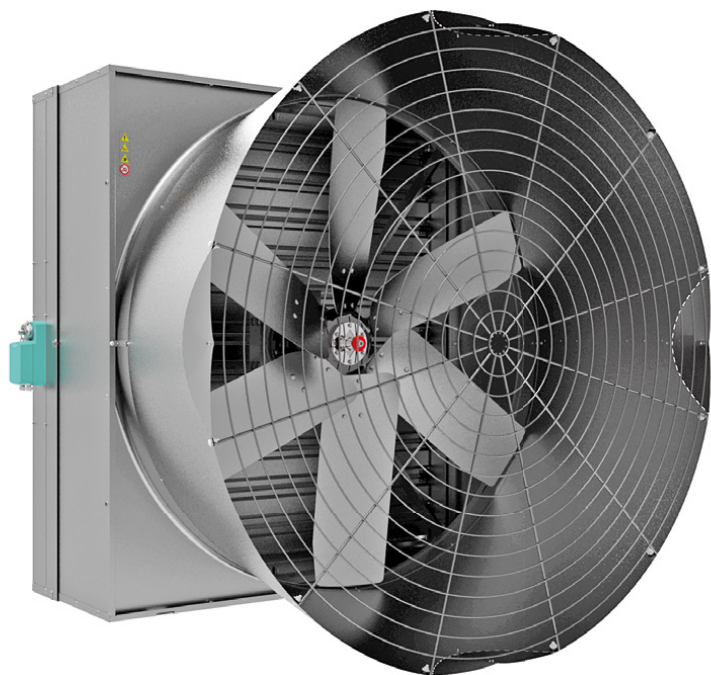

## Technical features

# G EOC 53

G EOC 53 - test number Bess Lab: 22357

Model	Voltage	Frequency	Propeller rotation speed (0 Pa - 0 inH <sub>2</sub> O)	Air flow				Absorbed power (0 Pa - 0 inH <sub>2</sub> O)	Absorbed power (25 Pa - 0.10 inH <sub>2</sub> O)	Specific power input (0 Pa - 0 inH <sub>2</sub> O)	Specific power input (25 Pa - 0.10 inH <sub>2</sub> O)	Ventilating Efficiency Ratio (0 Pa - 0 inH <sub>2</sub> O)	Ventilating Efficiency Ratio (25 Pa - 0.10 inH <sub>2</sub> O)
				0 Pa 0 inH <sub>2</sub> O	12 Pa 0.05 inH <sub>2</sub> O	25 Pa 0.10 inH <sub>2</sub> O	50 Pa 0.20 inH <sub>2</sub> O						
G EOC 53	3ph - 380-480V	50/60 Hz	560 RPM	31.900 cfm	31.100 cfm	30.400 cfm	28.500 cfm	1924 W	2130 W	35 W/ (1000m <sup>3</sup> /h)	41 W/ (1000m <sup>3</sup> /h)	16,6 cfm/W	14,3 cfm/W
				54.300 m <sup>3</sup> /h	52.800 m <sup>3</sup> /h	51.600 m <sup>3</sup> /h	48.400 m <sup>3</sup> /h						
			520 RPM	28.800 cfm	27.700 cfm	26.800 cfm	24.500 cfm	1375 W	1568 W	28 W/ (1000m <sup>3</sup> /h)	34 W/ (1000m <sup>3</sup> /h)	20,9 cfm/W	17,1 cfm/W
				48.900 m <sup>3</sup> /h	47.100 m <sup>3</sup> /h	45.500 m <sup>3</sup> /h	41.600 m <sup>3</sup> /h						
			450 RPM	25.900 cfm	24.900 cfm	23.700 cfm	21.000 cfm	1039 W	1212 W	24 W/ (1000m <sup>3</sup> /h)	30 W/ (1000m <sup>3</sup> /h)	24,9 cfm/W	19,5 cfm/W
				44.000 m <sup>3</sup> /h	42.300 m <sup>3</sup> /h	40.200 m <sup>3</sup> /h	35.700 m <sup>3</sup> /h						
			390 RPM	22.500 cfm	21.300 cfm	19.900 cfm	15.500 cfm	685 W	828 W	18 W/ (1000m <sup>3</sup> /h)	24 W/ (1000m <sup>3</sup> /h)	32,9 cfm/W	24 cfm/W
				38.300 m <sup>3</sup> /h	36.200 m <sup>3</sup> /h	33.800 m <sup>3</sup> /h	26.400 m <sup>3</sup> /h						
			340 RPM	19.600 cfm	18.000 cfm	16.300 cfm	9.300 cfm	474 W	595 W	14 W/ (1000m <sup>3</sup> /h)	21 W/ (1000m <sup>3</sup> /h)	41,3 cfm/W	27,5 cfm/W
				33.300 m <sup>3</sup> /h	30.600 m <sup>3</sup> /h	27.700 m <sup>3</sup> /h	15.700 m <sup>3</sup> /h						

Tested according to ANSI/AMCA 210-07 ANSI/ASHRAE 51-07 complying with ASABE/S565 OCT 2005.

Note: All fans tested with shutter and protection net.



## Dimensions and loading possibilities

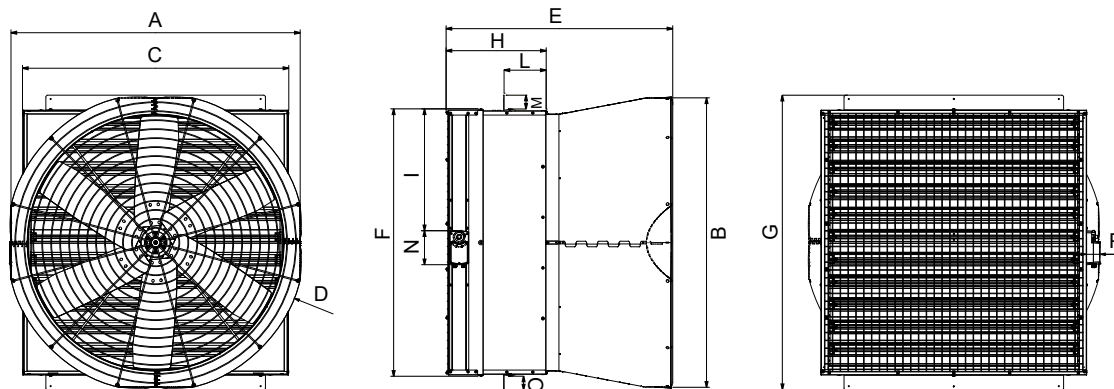

Dimension	G EOC 53
Dimension - A - [mm]	1515
Dimension - B - [mm]	1515
Dimension - C - [mm]	1395
Dimension - D - [Ø mm]	1562
Dimension - E - [mm]	1187
Dimension - F - [mm]	1400
Dimension - G - [mm]	1544
Dimension - H - [mm]	524
Dimension - I - [mm]	638
Dimension - L - [mm]	220
Dimension - M - [mm]	72
Dimension - N - [mm]	178
Dimension - O - [mm]	72
Dimension - P - [mm]	70

Characteristics	G EOC 53
Weight - kg	135

Loading possibilities on pallet	G EOC 53
Fully assembled version (FA)*	
LxWxH - mm	2290x1500x2100
N° pieces	5
Gross weight - kg	750

Loading possibilities	G EOC 53	
	Fully assembled version (FA)*	Knock-down version (KD)
Container 20ft	20	120
Container 40ft	40	240
Truck	45	240

\*Fan body and shutter are delivered pre-assembled, whereas the cone (in sectors), brackets and front cone safety nets are delivered separately in flat pack form.

State of the art brushless motor direct drive circulation fan. Wallhousing in strong galvanized steel and 6 blades propeller in Peraluman ensure high corrosion resistance. Designed to guarantee an excellent airflow/efficiency both at full and low airspeed. Integrated PI controller.

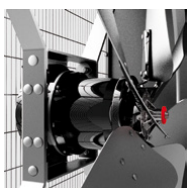

Direct-drive brushless motor, 3 configurable inputs/outputs (digital input on-off, 0-10V speed control input, 0-10V analog output)

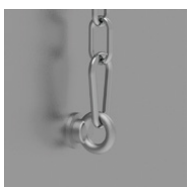

4 secure suspension eyes included



Sturdy motor's brackets to avoid impeller vibrations

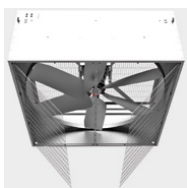

Hinged opening guards

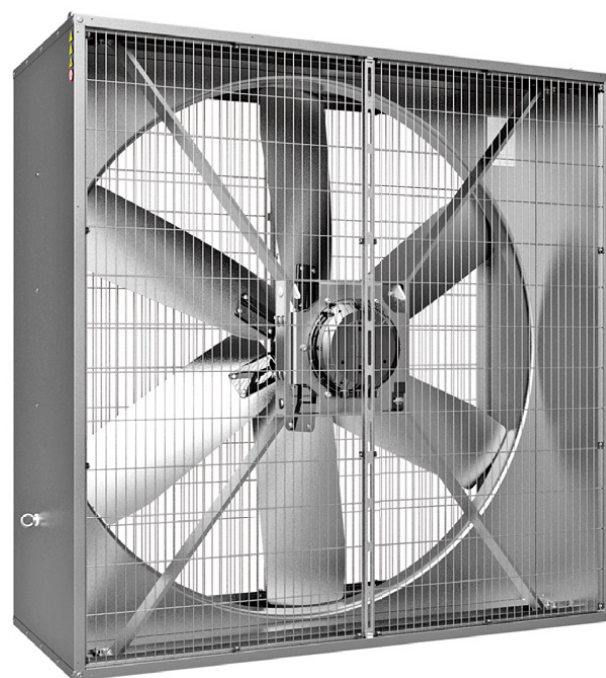

# Technical features

# G EOR 53

G EOR 53 - AMCA 230-15 test number Bess Lab: c222346-c22345-c22344

Model	Voltage Frequency	Propeller rotation speed	Thrust	Absorbed power	Thrust efficiency ratio	Air flow	Air flow*	Specific power input	Efficacy	
G EOR 53-35	Δ 220-240 V Y 380-420 V  50/60 Hz	560 RPM	35,4 lbf	2097 W	16,9 lbf/kW	29.300 ccfm	41.430 ccfm	42,1 W/(1000 m³/h)	14 ccfm/W	
						49.780 m³/h	70.400 m³/h			
		520 RPM	31,2 lbf	1715 W	18,2 lbf/kW	27.500 ccfm	38.890 ccfm	36,7 W/(1000 m³/h)	16,1 ccfm/W	
						46.720 m³/h	66.075 m³/h			
G EOR 53-25.1		Δ 220-240 V Y 380-420 V  50/60 Hz	460 RPM	25,13 lbf	1202 W	20,9 lbf/kW	24.700 ccfm	34.931 ccfm	28,6 W/(1000 m³/h)	20,6 ccfm/W
							41.960 m³/h	59.350 m³/h		
G EOR 53-25.2			400 RPM	18,84 lbf	805 W	23,4 lbf/kW	21.400 ccfm	30.264 ccfm	22,1 W/(1000 m³/h)	26,6 ccfm/W
							36.360 m³/h	51.420 m³/h		
G EOR 53-25.2	340 RPM		13,26 lbf	508 W	26,1 lbf/kW	17.900 ccfm	25.310 ccfm	16,7 W/(1000 m³/h)	35,3 ccfm/W	
						30.410 m³/h	43.000 m³/h			

\*Using ANSI/AMCA Standard 230-99 method.  
**Note:** tested with two safety nets.



## Dimensions and loading possibilities

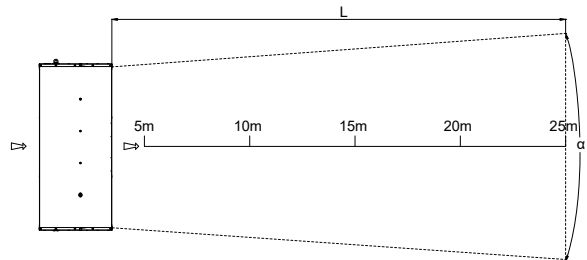
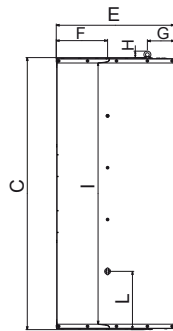
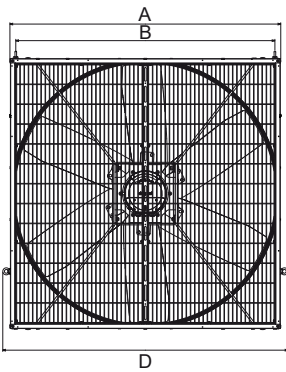

Air outlet cone

Model	α	L (Air speed 0,2 m/s)	Air speed (5 m)	Air speed (10 m)	Air speed (15 m)	Air speed (20 m)	Air speed (25 m)
G EOR 53-35	68°	40	5,8	3,2	2,7	2,3	1,6
G EOR 53-25.1	44°	38	3,8	2,7	2,3	1,9	1,2
G EOR 53-25.2	39°	35	3,5	2,4	2	1,6	1,1

Dimension	G EOR 53
Dimension - A - [mm]	1385
Dimension - B - [mm]	1325
Dimension - C - [mm]	1391
Dimension - D - [Ø mm]	1336
Dimension - E - [mm]	605
Dimension - F - [mm]	262
Dimension - G - [mm]	139
Dimension - H - [mm]	33
Dimension - I - [mm]	1458
Dimension - L - [mm]	298
Sound pressure level Lpa [dB]*	77,1 dB
Weight [kg]	103-99

Loading possibilities on pallet		G EOR 53
Fully assembled version (FA)		
LxWxH - mm		2420x1500x2250
N° pieces		5
Gross weight - kg		550

Loading possibilities		
	Fully assembled version (FA)	Knock-down version (KD)
Container 20ft	16	100
Container 40ft	33	200
Truck	45	250

\*Measurement surface according to UNI EN ISO 3744. pic C.7



**TERMOTECNICA PERICOLI S.r.l.**  
Regione Rapalline, 44 - 17031 Albenga, Italia  
tel. 0182 589006 fax 0182 589005 pit@pericoli.com

**PERICOLI ASIA PACIFIC Sdn. Bhd.**  
pap@pericoli.com

**PERICOLI CENTRO AMERICA**  
pca@pericoli.com

**PERICOLI MIDDLE EAST**  
pme@pericoli.com

**PERICOLI INDIA Pvt. Ltd.**  
pin@pericoli.com

[pericoli.com](http://pericoli.com)



**PERICool** are registered trademarks by Termotecnica Pericoli S.r.l.